



## **Operation Manual**

**Model: Silver 8 Screed**

**Covers Serial Number Range:**

**753-R-13TZT\*Y2-03753 through \_\_\_\_\_**

**Sold & Serviced By:**

--

## California Proposition 65 Warnings

### **WARNING**

**Breathing diesel engine exhaust exposes you to chemicals known to the State of California to cause cancer and birth defects or other reproductive harm.**

**Always start and operate the engine in a well-ventilated area.**

**If in an enclosed area, vent the exhaust to the outside.**

**Do not modify or tamper with the exhaust system.**

**Do not idle the engine except as necessary.**

**For more information go to [www.P65Warnings.ca.gov/diesel](http://www.P65Warnings.ca.gov/diesel)**

### **WARNING**

**Batteries, battery posts, battery terminals, and related accessories can expose you to chemicals including lead and lead compounds, which are known to the State of California to cause cancer and birth defects or other reproductive harm.**

**For more information go to [www.P65Warnings.ca.gov](http://www.P65Warnings.ca.gov)**

## Table of Contents

<b>1. Introduction.....</b>	<b>4</b>
1.1 Screed Components .....	4
<b>2. Safety.....</b>	<b>5</b>
2.1 General Safety.....	5
2.1.1 Safety Alert And Signal Words .....	5
2.2 Operation Hazards .....	5
2.2.1 Pressurized Fluids.....	7
2.2.2 Hazardous Chemicals .....	8
2.2.3 California Proposition 65 Warnings.....	8
2.2.4 Hazards From Modifying Equipment.....	8
2.3 Maintenance Hazards .....	8
2.3.1 Maintenance And Service .....	9
2.3.2 Fire Or Explosion Prevention .....	9
2.4 Safety Decals .....	9
<b>3. Screed Operation.....</b>	<b>11</b>
3.1 Screed Adjustments .....	11
<b>4. Setting Up Screed to Pave.....</b>	<b>12</b>
4.1 Definition of Points .....	12
4.2 Setting Main Screed Crown .....	12
4.3 Set Match height .....	13
4.4 Setting Extension Bottom Angle of Attack .....	14
4.4.1 Extension Bottom Angle of Attack Adjustment.....	14
<b>4.5 Set Pre-Strike Off.....</b>	<b>15</b>
4.5.1 Measure Pre-Strike Off.....	15
4.5.2 Pre-Strike Off Adjustment.....	15
<b>5. Setting Screed to Pave.....</b>	<b>16</b>
5.1 Before you Pave.....	16
5.2 Nulling The Screed & Setting Angle of Attack .....	16

# 1. Introduction

## 1.1 Screed Components

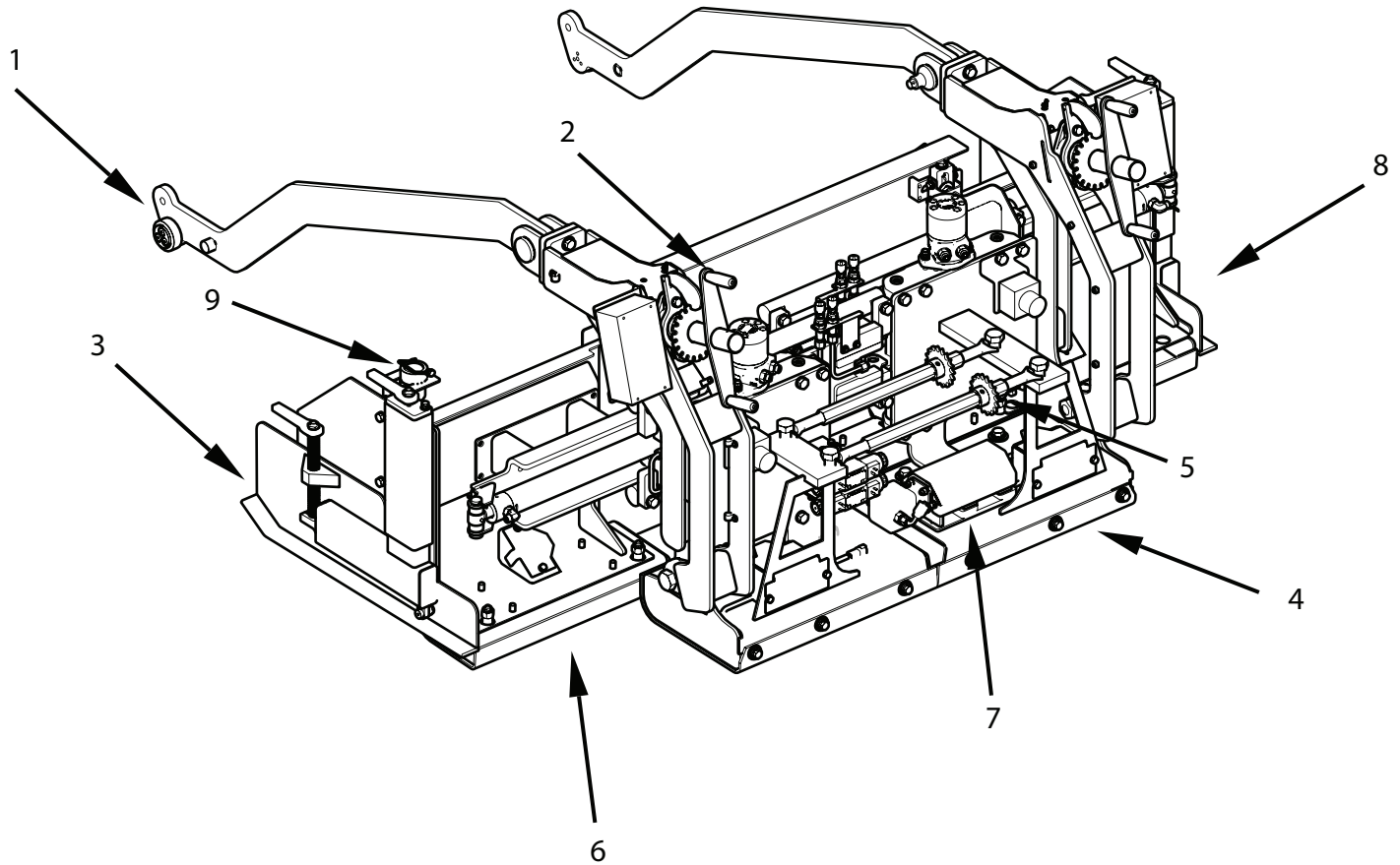

1. Tow Arm
2. Depth Handle Adjustment
3. Endgate
4. Main Screed
5. Crown Adjustment
6. Left Extension
7. Vibrator Assembly
8. Right Extension

## 2. Safety

### 2.1 General Safety

Operating personnel must perform service checks regularly to be sure systems are in good operating condition. If abnormal conditions are detected, inform maintenance personnel immediately.

Check all systems for proper operation. Check chassis and all components for physical damage and security of all fasteners and connectors.

#### 2.1.1 Safety Alert And Signal Words

The safety information in this manual is denoted by the safety alert symbol: This symbol means ATTENTION! BECOME ALERT! YOUR SAFETY IS INVOLVED!

##### **DANGER**

Indicates a hazardous condition that will result in serious injury or death if not performed appropriately.

##### **WARNING**

Indicates a hazardous condition that could result in serious injury or death if not performed appropriately.

##### **CAUTION**

Indicates a hazardous condition that could result in serious injury if not performed appropriately.

##### **NOTICE**

Indicates a situation that could result in damage to the machine or other property.

### 2.2 Operation Hazards

The following hazards are possible during the operation of the paver. All operators, maintenance and service personal, or any one working with or near the paver must be familiar all hazards.

##### **WARNING**

Do not operate this paver until you read and understand the instructions in the operation section of this manual.

##### **WARNING**

Do not operate, work on or around paver while under the influence of alcohol, drugs or if feeling ill.

**⚠ WARNING**

**Explosion, fire, or property damage hazard.**

**Do not use starting fluid with this engine.**

**Use of starting fluid can cause an explosion, fire, personal injury or damage to the engine and other property.**

**⚠ WARNING**

**Loud noise hazard.**

**Prolonged exposure to loud noise can cause impairment or loss of hearing.**

**Operators, workers and bystanders must use ear protection while machine is in operation.**

**⚠ WARNING**

**Entanglement hazard.**

**Do not wear loose fitting clothing.**

**Loose fitting clothing and long hair can become entangled in moving or rotating parts. Keep all personnel clear of moving parts when engine is running or about to be started.**

**Long hair must be tied back or netted.**

**Keep clear of moving components.**

**Never operate machine with open or missing guards or shields.**

**⚠ WARNING**

**Fire, burns or property damage hazard.**

**During aftertreatment regeneration, exhaust gas temperature could reach 1500°F (800°C). Exhaust system surface could exceed 1300°F (700°C) which is hot enough to ignite or melt common materials and burn the skin.**

**Exhaust and exhaust components can remain hot after engine has been stopped.**

**To avoid risk of fire, burns and property damage or personal injury, allow the exhaust system to cool before service or repairs.**

**Be sure there are no combustible materials located where they are likely to come in contact with hot exhaust or exhaust components.**

**⚠ WARNING**

**Explosion, fire, or personal injury.**

**This engine is equipped with an air intake heater.**

**Do not use starting fluid with this engine.**

**Use of starting fluid can cause an explosion, fire, personal injury or damage to the engine and other property.**

**⚠ WARNING**

**Diesel exhaust fluid (DEF) hazard.**

**In case of contact with eyes, immediately flush eyes with water. Obtain medical attention immediately.**

**In case of skin contact, wash all exposed skin area with mild soap and water, followed by warm water rinse.**

**If ingested, obtain medical attention immediately.**

**⚠ WARNING**

**Crush hazard.**

**A raised screed or partially open hopper will fall if a hydraulic line or fitting is opened, or manual override button on hydraulic valve is pressed.**

**Always fully close hopper and lower screed to ground or engage screed service locks when parking paver or preparing paver for inspections, service and maintenance.**

**⚠ NOTICE**

**Dispose of waste properly.**

**Improper disposal of waste can harm the environment.**

**Use leak proof container when draining fluids. Do not use food or beverage containers.**

**Contact your local environmental or recycling center for the proper way to recycle or dispose of waste.**

## **2.2.1 Pressurized Fluids**

Hydraulic oil and grease injected into your skin can cause serious injury or death. Keep your hands and body away from any pressurized leak. Tighten connections before applying pressure. Never use your hand to check for leaks; use a piece of wood or cardboard. If fluid is injected into the skin, it must be surgically removed within a few hours or gangrene may result. Get immediate medical attention.

## 2.2.2 Hazardous Chemicals

Lubricants and coolants can be hazardous. Before operating, check the Material Safety Data Sheet (MSDS) to understand each product, safe handling procedures, and first aid measures relating to the product. Clean up spilled fluids immediately.

Do not drain or pour any fluids or lubricants on the ground. Check with local environmental agencies or recycling centers for proper disposal information.

## 2.2.3 California Proposition 65 Warnings

### **WARNING**

**Breathing diesel engine exhaust exposes you to chemicals known to the State of California to cause cancer and birth defects or other reproductive harm.**

**Always start and operate the engine in a well-ventilated area.**

**If in an enclosed area, vent the exhaust to the outside.**

**Do not modify or tamper with the exhaust system.**

**Do not idle the engine except as necessary.**

**For more information go to [www.P65Warnings.ca.gov/diesel](http://www.P65Warnings.ca.gov/diesel).**

### **WARNING**

**Batteries, battery posts, battery terminals, and related accessories can expose you to chemicals including lead and lead compounds, which are known to the State of California to cause cancer and birth defects or other reproductive harm.**

**For more information go to [www.P65Warnings.ca.gov](http://www.P65Warnings.ca.gov).**

## 2.2.4 Hazards From Modifying Equipment

Do not make any alterations to your paver. Altering may cause your equipment to be unsafe and may void the manufacturers' warranty.

Always use Mauldin replacement parts.

## 2.3 Maintenance Hazards

The following maintenance hazards are in addition to those found while operating the paver. All maintenance and service personnel must be familiar with all hazards before working on the machine.

Most accidents are caused by failure to observe basic safety rules or precautions.

An accident can often be avoided by recognizing potentially hazardous situations before an accident occurs.



**⚠ WARNING**

**Improper operation, lubrication or maintenance of this paver can be dangerous and could result in injury or death.**

**⚠ WARNING**

**Do not perform any lubrication and maintenance on this paver until you read and understand the instructions in the maintenance section of this manual.**

## **2.3.1 Maintenance And Service**

Before performing inspections, service or maintenance:

- Park paver on firm level surface.
- Lower screed to ground or engage screed support locks.
- Fully open or close hoppers.
- Turn engine off and remove ignition key.
- Attach a Do Not Operate tag or similar warning tag to the ignition switch.
- Follow lockout/tag out procedure as defined by your company.

After performing inspections, service or maintenance, verify all guards have been installed and all safety devices are functional.

Always wear face or eye protection, safety shoes, and other protective items as required by your company.

If you must troubleshoot machine with engine running, have someone in constant visual contact who can shut off the engine or engage an Emergency Stop.

If you must service machine with an attachment raised, block up that attachment in a safe position.

## **2.3.2 Fire Or Explosion Prevention**

Engine fuel can cause an explosion or fire. Do not service fuel system with engine running or near open fire. Do not weld or smoke near fuel system. Do not spill fuel or hydraulic oil on hot machine components. Clean up spilled fuel or oils immediately.







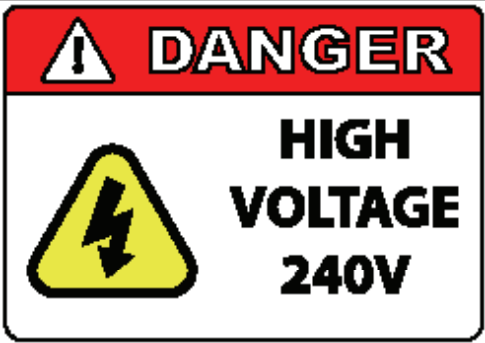

Keep sparks and flames away from batteries to prevent explosion of hydrogen gas in and near a battery. Other precautions include:

- When disconnecting battery cables, disconnect negative (-) cable first.
- When connecting battery cables, connect negative (-) cable last.
- Do not short circuit battery posts with metal items.

## **2.4 Safety Decals**

Safety decals are located on the paver to identify operational and maintenance hazards. The safety decals are placed according to the hazard in that area of the paver. Read and understand each of the safety decals and the hazard it references. These safety messages are additional information to the safety content described in this operator's manual.

All safety decals must be legible at all times. Avoid using harsh chemicals or pressure washing. If the safety decal is no longer legible, replace it with a new one. Contact your dealer for new decals.

	<p>1 - Danger High Voltage. The generator provides 250v for screed heater operation. Avoid working on any electrical components while the engine is on.</p>
	<p>2 - Danger Keep Clear. There are moving objects that could result in harm. Keep clear of moving objects. Failure to keep clear may result in serious injury or death.</p>
	<p>3 - Danger Stand Back. There are moving objects that could result in harm. Stand back a safe distance to avoid harm. Failure to keep back may result in serious injury or death.</p>
	<p>4 - Danger Crush Hazard. There are moving objects with sharp and or hard edges. Failure to observe moving parts and keep clear can and will result in serious injury.</p>
	<p>5 - Fan Hazard. Keep away from moving fan.</p>
	<p>6 - Danger High Voltage. This machine uses 250v to operation. Avoid working on any electrical components while the engine is on.</p>
	<p>7 - Caution Moving Augers. Keep clear of moving augers. Failure to do so may result in serious injury or death. Do not stand on or near the augers at any time, even if the machine is not running.</p>
	<p>8 - Danger. Fuel and or flammable fluid is present. Do not smoke or use any open flame. Decal is inside engine enclosure.</p>

### 3. Screed Operation

#### 3.1 Screed Adjustments

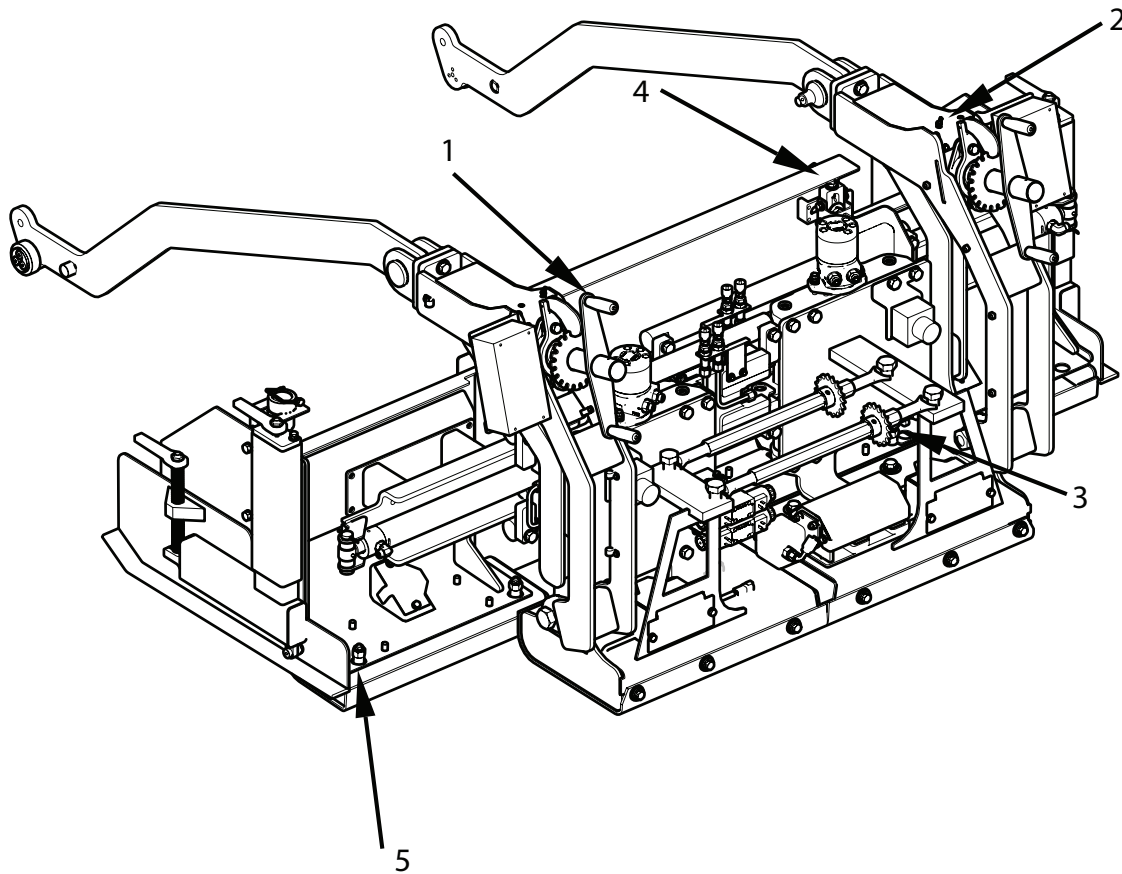

1. Material Depth Thickness: Changes the angle of attack for the whole screed.
2. Extension Match Height: Raises and Lowers the Extension in relation to the Main Screed
3. Main Screed Crown Adjustment: Crowns and Inverts the Main screed plate
4. Pre-strike off height adjustment: Raises and lowers the Pre-strike off plate
5. Extension Bottom Angle of Attack: Changes the angle of the Extension Bottom

## 4. Setting Up Screed to Pave

### 4.1 Definition of Points

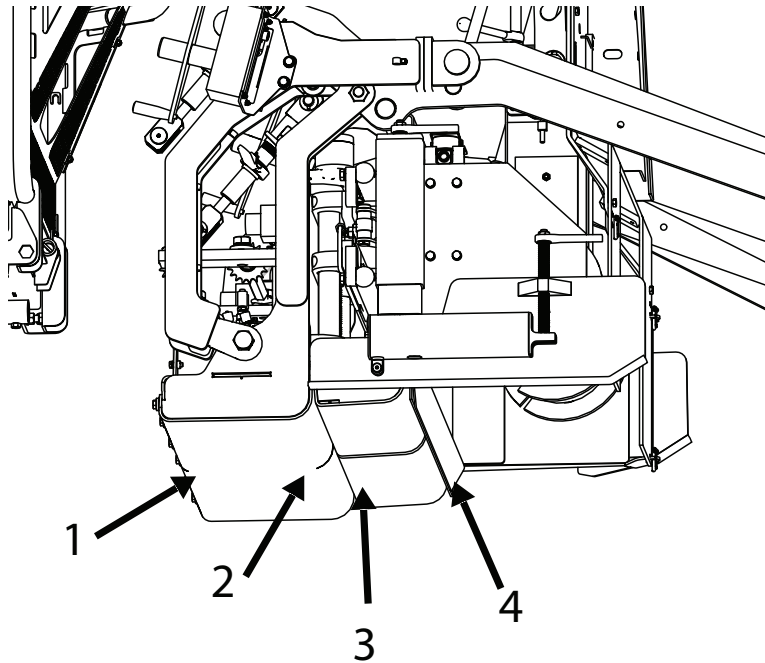

1. Main Screed Bottom Trailing Edge
2. Main Screed Bottom Leading Edge
3. Extension Bottom Trailing Edge
4. Prestrike off

### 4.2 Setting Main Screed Crown

#### Warning

#### Crush Hazard

1. Adjust Tow Point Cylinders so that they are both showing the same amount of cylinder.
2. Null the Depth Handles.
3. Raise screed and run a string across the leading edge of the main screed bottom. Shown by #1. \*\*String must be on flat bottom side of screed bottom.
4. Adjust the forward ratchet jack so that there is a 1/16in gap between the screed bottom and the string line. Shown by #3. (next page)
5. Now remove the string and run it across the trailing edge of the screed bottom. Shown by #2.
6. Adjust the rear ratchet jack so that the string is completely flush with the screed bottom.

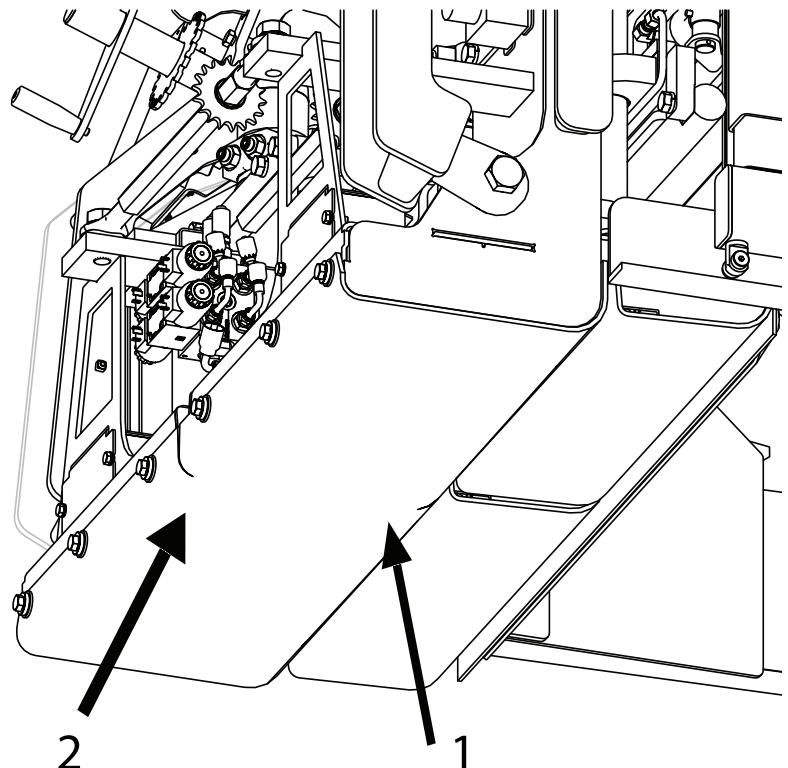

\*\*Verify the crown is flush/flat and not positive, adjust the ratchet jack until there is a gap, then adjust until it is flush.

7. Check the front leading edge again and verify 1/16th gap.
8. Recheck trailing edge of screed bottom, and verify flush.
9. Repeat steps until measurements are exact.

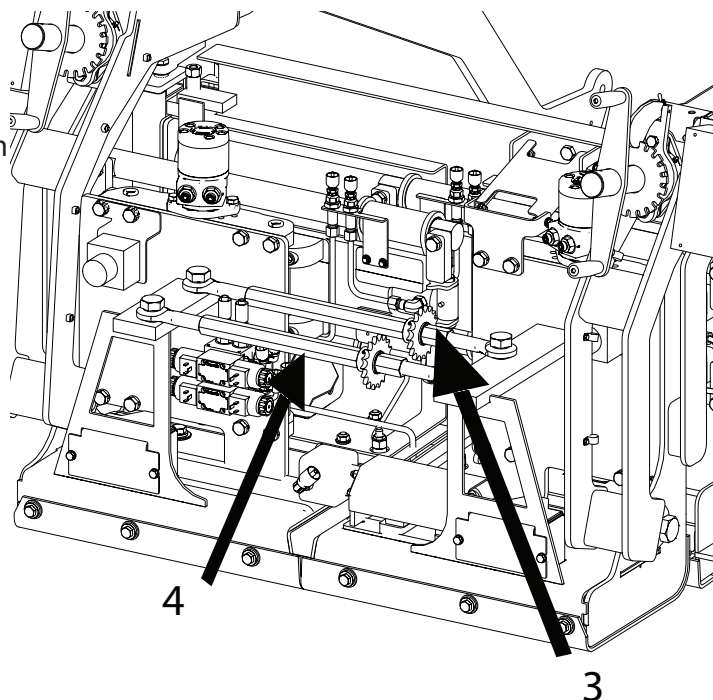

### 4.3 Set Match height

1. With the extensions completely closed, adjust the screed extension match height setting until the extension bottom trailing edge is flush with the main screed bottom.
2. Use a straight edge to verify shown by the illustration below.

To adjust the match height use the Match Height Toggle located on top of the screed arm shown below.

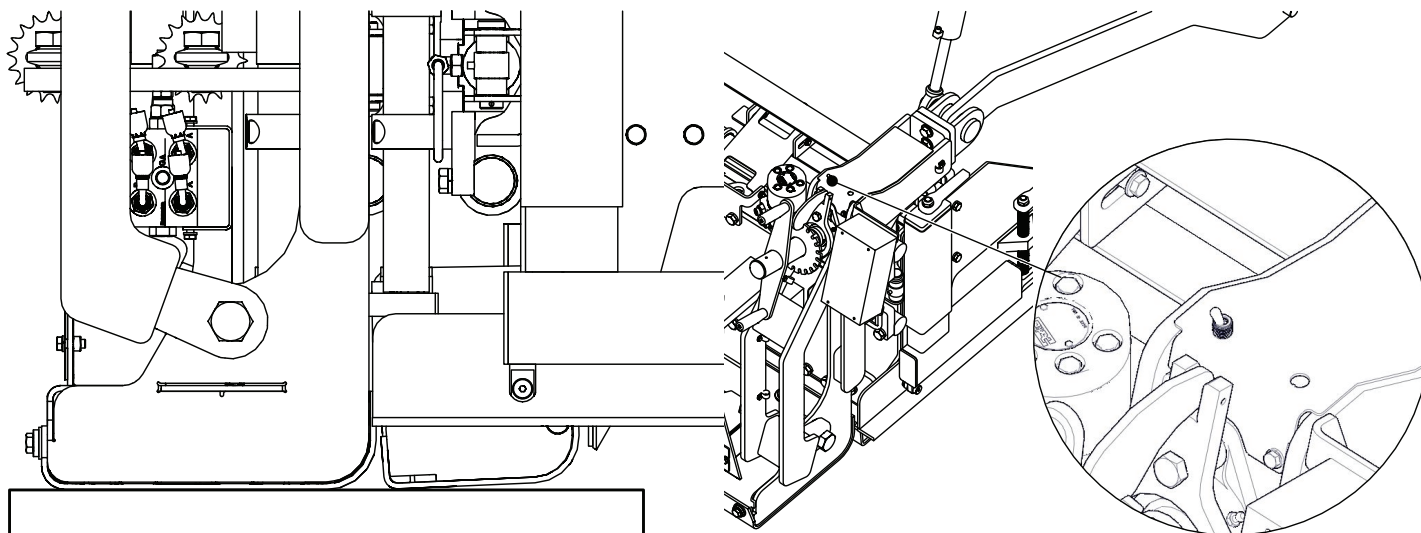

## 4.4 Setting Extension Bottom Angle of Attack

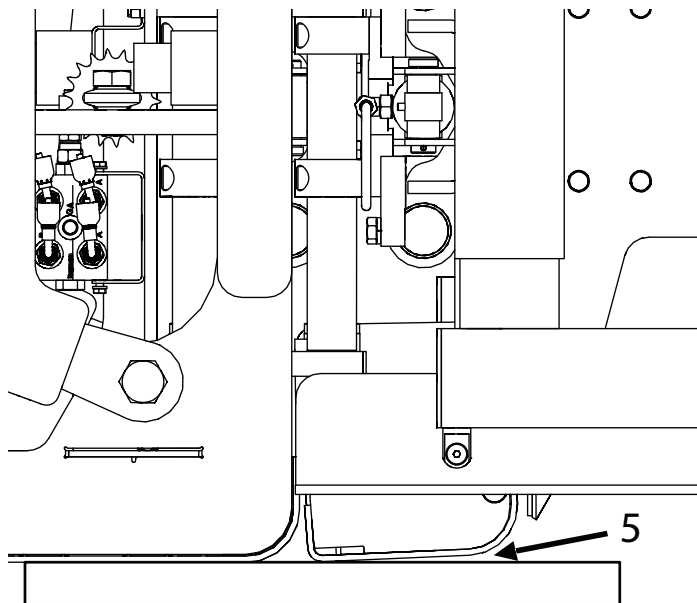

1. Measure the distance marked by #5.
2. With the straight edge flush against the main screed bottom and the trailing edge of the extension bottom, there should be a gap from the straight edge to the leading edge of the extension bottom. This measurement should be 1/4in.

### 4.4.1 Extension Bottom Angle of Attack Adjustment

You can adjust the angle of attack turning the threaded studs shown by #6. Loosen the jam nut on top and turn the boss clockwise for increased angle of attack, or counter clockwise for less. If you adjust angle of attack you will need to reset match height.

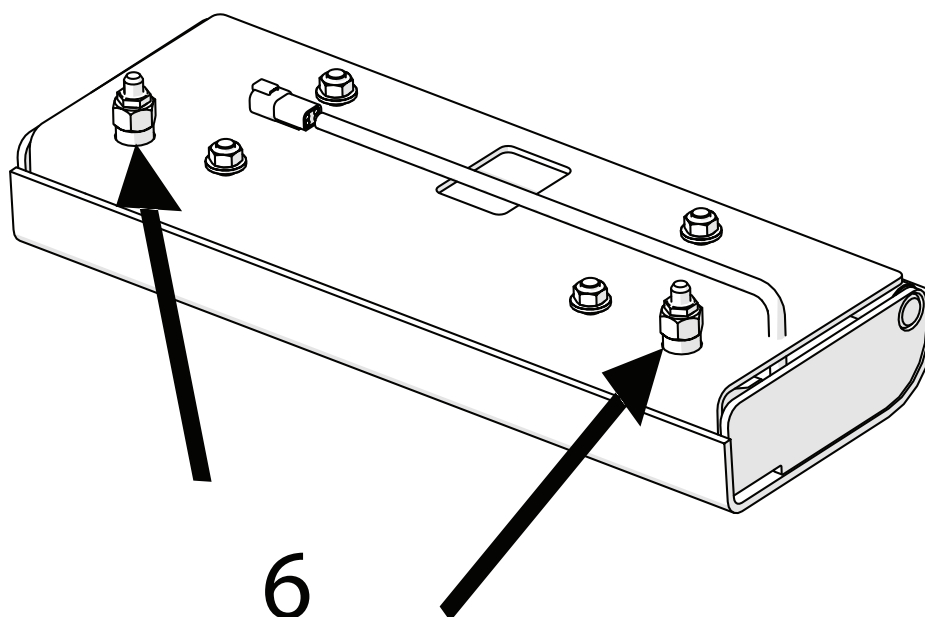

## 4.5 Set Pre-Strike Off

### 4.5.1 Measure Pre-Strike Off

You **MUST** have completed all previous steps before setting pre-strike off.

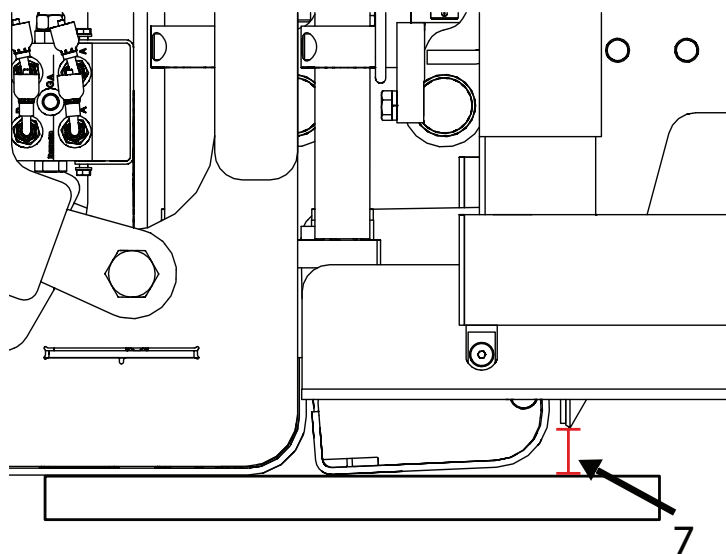

1. Position the flat edge on the bottom of the screed.
2. Take a measurement from the straight edge to the pre-strike off 6in in from the outside edge of the pre strike off. You will need to take both measurements from each side of the pre-strike off.

Typically a gap of 3/4in to 1in will allow for lifts of 5in to 6in.

### 4.5.2 Pre-Strike Off Adjustment

To adjust the pre-strike off, use the bolt located on top of the pre-strike off, shown by #8. Loosen the lock nut and turn the bolt counter-clockwise to increase the pre-strike off adjustment, or clockwise to decrease the adjustment.

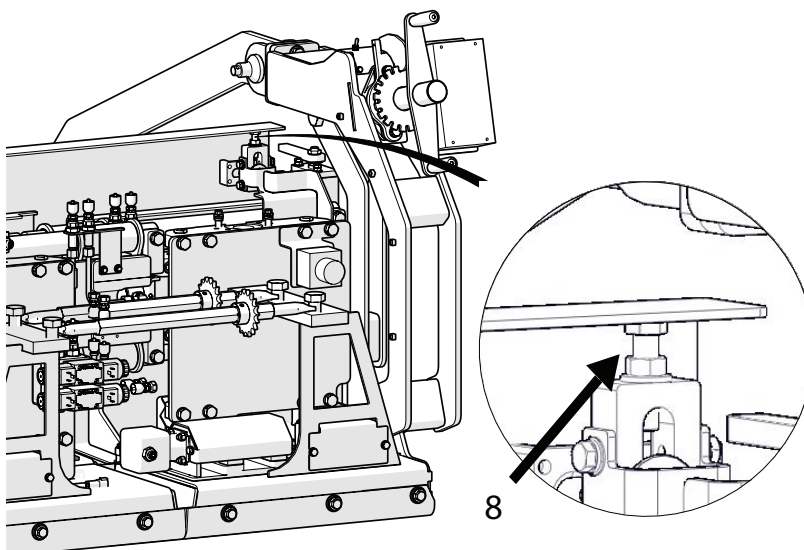

## 5. Setting Screed to Pave

### 5.1 Before you Pave

The Screed must be elevated a distance equal to the desired mat depth plus enough extra height to allow for compaction. to achieve this, the most popular methods are; an existing asphalt pad and/or starting blocks.

- Starting blocks - a 2.5in thick starting block is good for starting block for a compacted mat of 2in.
- Compacted asphalt pad - a starting block equal to compaction amount will be needed.
- Non-compacted asphalt pad - no block needed.

### 5.2 Nulling The Screed & Setting Angle of Attack

#### **WARNING**

#### **Crush Hazard**

**A raised screed may lower unexpectedly.**

**Engage screed support locks to support screed.**

**Do not place any part of body under screed.**

This is the adjustment of the screed to the perfectly flat position on either the starting blocks or the asphalt pad. to null the screed follow this procedure:

1. Lower screed completely onto the starting surface, (blocks or pad)
2. Rotate the screed depth handles until you locate the position of free movement.  
This is a limited area where the depth cranks will both rotate freely in either direction.
3. Rotate thickness screw two full rotations, (in thicker direction). Start paving and make adjustments as required.



